

SR03 Sealed Rivet

Dome head · Copper body · Steel stem · Sealed
3.2 mm (1/8") - 4.8 mm (3/16")

Features

- Fully sealed and weather proof, sealed against moisture air and other contaminants
- Good hole fill and retained stem provide strong vibration resistant joints
- Higher tensile and shear strength than equivalent open end rivets

Material

- Body: Copper, polished
- Stem: Steel, protection layer

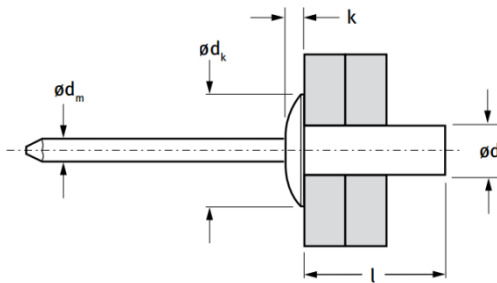

Before Placement

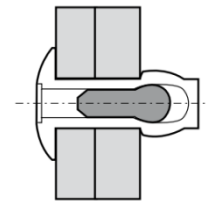

After Placement

Part No.	Size ø	Grip Range		Hole Size	ød	l	ød _k	k	ød _m	Shear (typical) kN	Tension (typical) kN
		min.	max.								
OSR03-03265	3.2 (1/8")	0.5	1.5	3.3	3.2	6.5	6.0 [±0.24]	1.4	1.70	0.85	1.3
OSR03-03280		1.5	3.0			8.0					
OSR03-03295		2.5	4.5			9.5					
OSR03-03212		4.5	7.5			12.5					
OSR03-04080	4.0 (5/32")	0.5	2.0	4.1	4.0	8.0	8.0 [±0.29]	1.7	2.18	1.35	2.0
OSR03-04010		2.0	4.0			10.0					
OSR03-04895	4.8 (3/16")	1.0	2.5	4.9	4.8	9.5	9.5 [±0.29]	2.0	2.63	1.95	2.8
OSR03-04811		2.5	4.5			11.5					



Can't find what you are looking for?

We can provide customized finishing and colouring.
Contact your nearest [Gripwell](#) team for assistance!